

# Office to let

## Globalworth Square

Bucharest, Sector 2, 44 Pipera Road



### Building information

Building status	Existing
Year of construction	2021
Parking ratio	1 / 40 sq m
Total building area	28 000 sq m

### Commercial terms

Office space*	after login *
Parking	after login *
Service charge*	after login *
Minimum lease term	after login *
Availability	after login *

\* Asking terms for m<sup>2</sup>/month

### Location



### Available space

Building completely leased

Typical floor plan

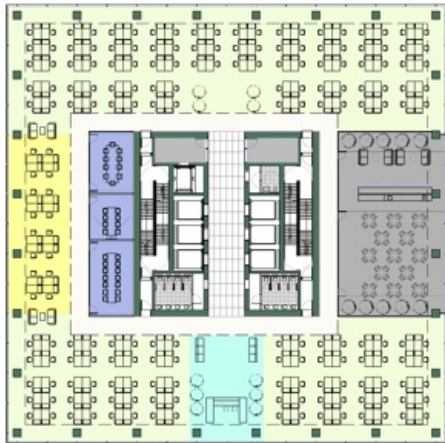

Public transport

Metro: M2

Bus: 135, 605

Contact



+40 21 302 3400

More information